

W.S. 67 *Fynspray* ULTRA GALLEY PUMP

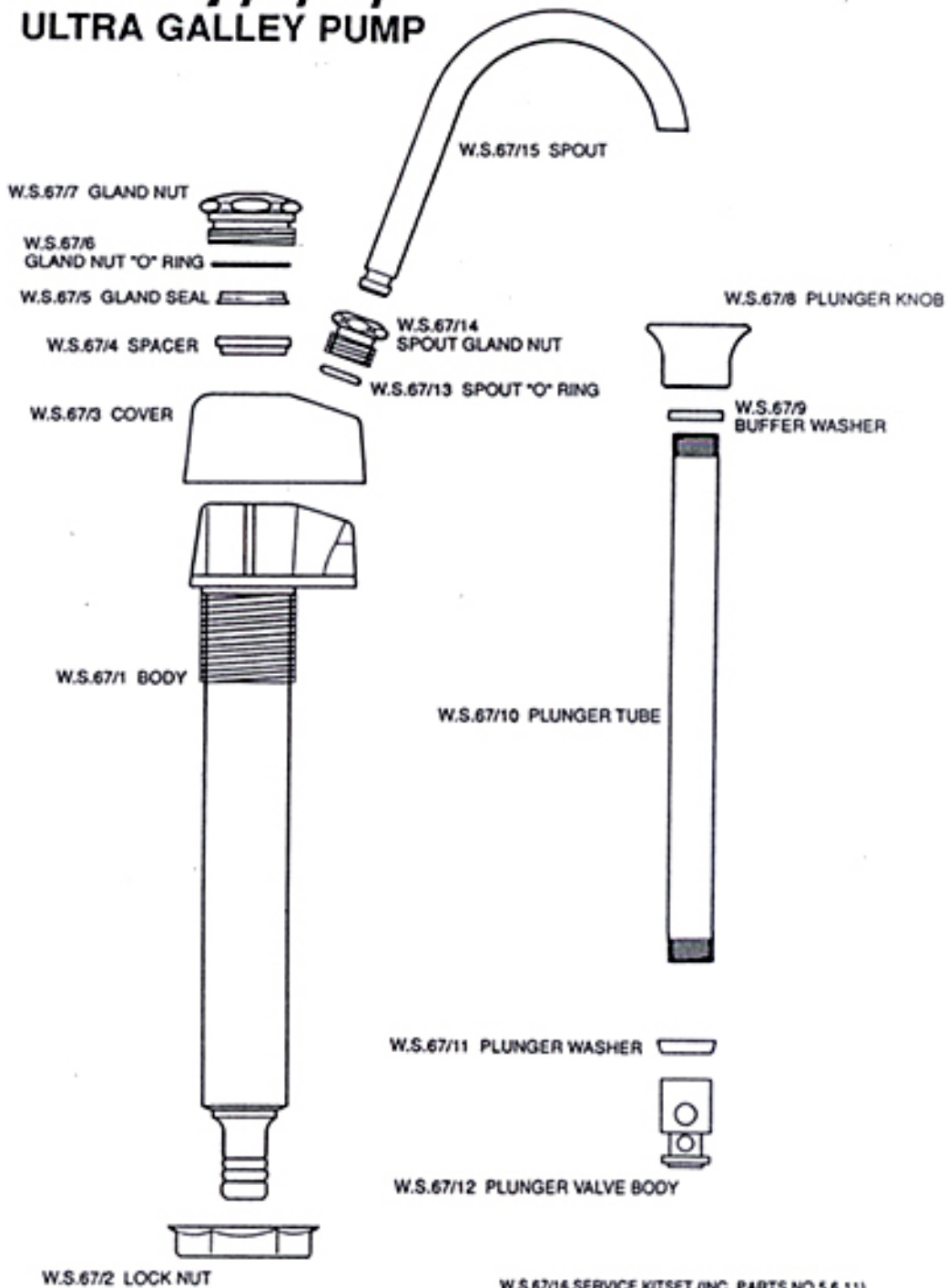

WS 67 Repair Instructions

To replace the plunger washer (#11) – Loss of suction.

Unscrew the gland nut (#7) which enables the complete plunger assembly to be removed. Check that the plunger washer (#11) is soft & pliable and that it is a push fit inside the pump barrel. If it is not a push fit and/or is cracked it must be replaced.

To replace the gland seal (#5) – Leaking of the gland.

Having removed the complete pump assembly (as above) unscrew the plunger valve body (#12) (earlier models unscrew the plunger knob (#8)). **DO NOT HOLD THE PLUNGER TUBE IN ANY TOOLS AS THEY MAY CAUSE DAMAGE.** When replacing or removing the gland seal onto the plunger wind it in the direction of the plunger thread so as not to damage the lip edge.

The gland nut 'o' ring (#6) is also included in the Service Kitset and whether replaced or not should be lubricated with a little vaseline.

Note that both the gland nut (#7) and the spout gland nut (#14) should not be over-tightened.

Parts #5,6,& 11 are contained in the service kitset.

IMTRA CORPORATION

30 Barnet Boulevard, New Bedford, MA 02745
Ph (508) 995 7000 Fax (508) 998 5359 Email fynspray@imtra.com

WS 67